

# State of Wyoming Corner Record

(In compliance with the *CORNER PERPETUATION AND FILING ACT*, Wyoming Statutes, 1997, Section 33-29-140, et. seq., and the Rules and Regulations of the Board of Registration for Professional Engineers and Professional Land Surveyors)

Reverse side of this form may be used if more space is needed.

Record of original survey and citation of source of historical information (if corner is lost or obliterated). Description of corner monumentation evidence found and/or monument and accessories established to perpetuate the location of this corner. Sketch of relative location of monument, accessories, and reference points with course and distance to adjacent corner(s) (if determined in this survey). Method and rationale for reestablishment of lost or obliterated corner.

**G.L.O. Record:** J. Wesley Hammond, U.S. Deputy Surveyor, July 13, 1872.  
40.00 chains Set sand stone 20 x 12 x 8 for 1/4 sec. cor.

**Subsequent Records:** State of Wyoming Corner Record filed by me on 3/03/2003 indicating a found 3 1/4" diameter aluminum cap.

**Set:** The above found monument was removed during the construction phase of the Wyoming Department of Transportation Project No. 0C02-00(071) Burns North. Upon the completion of the mentioned project and at the request of the Wyoming Department of Transportation, I reset the above found monument with a No. 5 x 24" rebar and 3 1/4" diameter Brass Cap marked as noted below, 0.1' below the recently constructed asphalt roadway.

### Brass Cap Markings

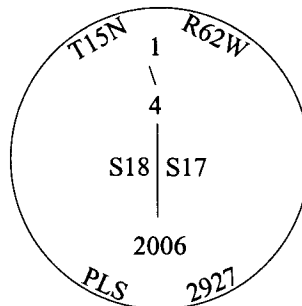

Date of Field Work: 7 September 2006

Office Reference: Burns North 26109

### CROSS INDEX DIAGRAM

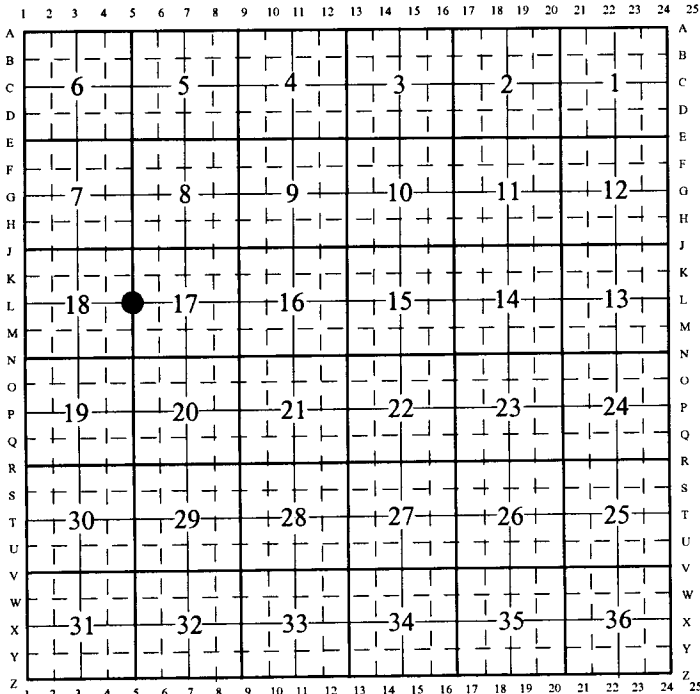

Firm/Agency, Address

Paul A. Reid, PLS  
1533 Pinion Drive  
Cheyenne WY  
Phone (307) 637-3400

This corner record was prepared by me or under my direction and supervision.

*SEAL & SIGNATURE*

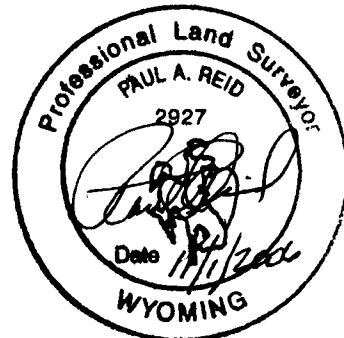

RECORDED 11/01/2006 AT 8:57 AM REC# 460495 3K# 1977 PG# 5  
DEBRA K. LATHROP, CLERK OF LARAMIE COUNTY, WY PAGE 1 OF 1

Corner Name: W1/4 Corner Section: 17 T.15 N., R. 62 W., 6th P.M.  
SBRPEPLS/PLSW: MARCH 1994/97

Cross-Index No.: L-5